

Belinson Railway Underpass

Location	Petach-Tikva, Israel
Date	2005
Services	Detailed design, design documentation and on-site supervision.
ABES member	ABES Israel - KEDMOR



Description

The Belinson Railway Underpass is designed to include longitudinal passage for vehicles during construction and trains in the final stage. The total length of this structure is 580m of which 180m are in a tunnel and the remainder is open. The design of the covered section is based on the cut & cover method. The passage walls are made as strengthening piers constructed from board and casting. The covered section gains full monolithic status for the structure. Two pedestrian passages 37m and 17m long are also part of this structure. Both include escalators and inclined ramps to ensure access for handicapped people.



Visualisation of finished underpass.

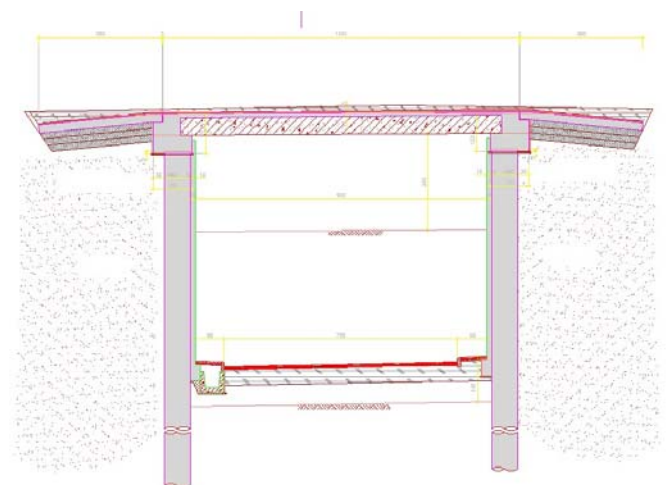

Cross-section of the covered part of the longitudinal passage.